

AggregatorTAP: 100Base-FX

100BASE-FX or 100BASE-LX | Portable | Aggregation and Breakout



Network test access points (TAPs) are hardware tools that allow you to access and monitor your network. TAPs are purpose-built hardware devices that let you see every bit, byte and packet.®

AggregatorTAPs are used to capture 100% full duplex traffic that can then be sent to multiple monitoring appliances to analyze your network. AggregatorTAPs supports aggregation and regeneration/SPAN modes, as well as tap 'breakout' mode, providing flexibility to manage your network.

Key Features

- Media conversion; 100Base-FX or 100Base-LX to copper
- Portable, Plug & Play
- Easy configuration; switches on back of TAP
- Supports tap 'breakout' and aggregation
- Supports jumbo frames
- 1U rack mount holds up to four portable TAPs
- Passes physical errors
- A & B live network ports are passive, zero interruption if network is powered up or down.
- 100% secure and transparent, no IP address, No MAC address; cannot be hacked
- Designed, manufactured, tested and certified in the USA

Network Flow

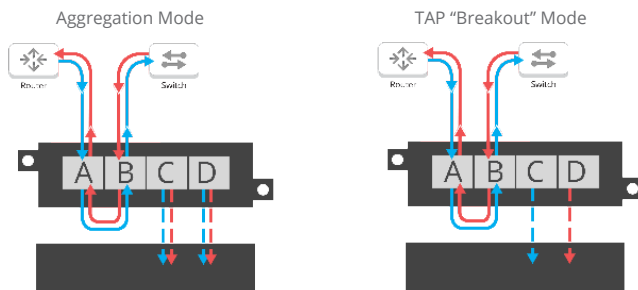

APPLICATIONS:

- Converting 100BASE-FX to copper Gigabit Ethernet for tool compatibility
- TAP once and send full duplex traffic to one or two separate tools
- Isolate eastbound and westbound traffic to separate monitor ports

SOLUTIONS:

Aggregating TAPs are ideal for:

- Wireshark
- Analzers
- Intrusion Detection System
- Application Performance Monitoring
- Lawful Intercept
- Packet Capture
- Data Forensics

Competitive Edge

- Media Conversion
- Supports aggregation or breakout
- Tested and Certified



Have Questions?

sales@garlandtechnology.com
+716.242.8500
garlandtechnology.com

AggregatorTAP: 100Base-FX

100BASE-FX | Portable | Aggregation and Breakout

Model #	Media		Modes			
	Network	Monitor	Breakout	Aggregation	Regeneration	Bypass
RMP-1U			1U Rack Mount Kit - Holds up to 4 Portable TAPs			
P100FXCA	2 100Base-FX	2 Copper - RJ-45 100/1000M (1Gbps)	Yes	Yes	No	No
P100LXCA	2 100Base-LX	2 Copper - RJ-45 100/1000M (1Gbps)	Yes	Yes	No	No

Note: P100FXCA is the multi-mode fiber option and P100LXCA is the single-mode fiber option.

Additional Specifications

Dimensions (HxWxD): 1.15" x 3.9" x 6.5" (29.21mm x 99.06mm x 165.10mm)

Weight: 0.7 lbs (0.32 kg)

Ambient Temperature: 0°C to 40°C (32°F to 104°F)

Storage Temperature: -20°C to 70°C (-4°F to +158°F)

Voltage: 5 DC

Current (nominal): < 1.6 Amps

Maximum consumption: < 8 Watts

Humidity: 90% non-condensing



This document is for informational purposes only. The information in this document, believed by Garland Technology to be accurate as of the date of publication, is subject to change without notice. Garland Technology assumes no responsibility for any errors or omissions in this document and shall have no obligation to you as a result of having made this document available to you or based upon the information it contains. ©2020 Garland Technology LLC. All Rights Reserved