

# 100BASE-FX Aggregator Network TAPs

100BASE-FX | Portable | Supports TAP "Breakout" and Aggregation



Network test access points (TAPs) are hardware tools that allow you to access and monitor your network. Aggregator TAPs are used to capture 100% full duplex traffic; the traffic can then be sent to multiple monitoring appliances to analyze your network. Aggregator TAPs are purpose-built hardware devices that let you see every bit, byte and packet.®

TAPs support aggregation and TAP 'breakout' modes providing flexibility to manage your network.

## Key Features

- Media conversion; 100Base-FX to copper
- Portable, Plug & Play
- Easy configuration; switches on back of TAP
- Supports Breakout and Aggregation
- Supports jumbo frames
- 1U rack mount holds up to four portable TAPs
- Passes physical errors
- A & B live network ports are passive, zero interruption if network is powered up or down.
- 100% secure and transparent, no IP address, No MAC address; cannot be hacked
- Designed, manufactured, tested and certified in the USA

## Network Flow

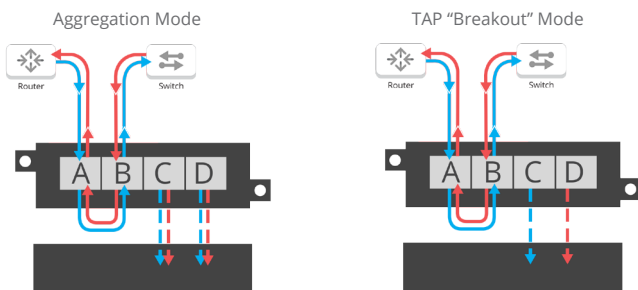

### APPLICATIONS:

- Converting 100BASE-FX to copper Gigabit Ethernet for tool compatibility
- TAP once and send full duplex traffic to one or two separate tools
- Isolate eastbound and westbound traffic to separate monitor ports

### SOLUTIONS:

Aggregating TAPs are ideal for:

- Wireshark
- Analyzers
- Intrusion Detection System
- Application Performance Monitoring
- Lawful Intercept
- Packet Capture
- Data Forensics

### Competitive Edge

- Media Conversion
- Supports aggregation or breakout
- Tested and Certified



### Have Questions?

sales@garlandtechnology.com  
+716.242.8500  
garlandtechnology.com

# 100BASE-FX Aggregator Network TAPs

100BASE-FX | Portable | Supports TAP "Breakout" and Aggregation

Model #	Media		Modes			
	Network	Monitor	Breakout	Aggregation	Regeneration	Bypass
RMP-1U			1U Rack Mount Kit - Holds up to 4 Portable TAPs			
P100FXCA	2 100Base-FX	2 Copper - RJ-45 100/1000M (1Gbps)	Yes	Yes	No	No

## Additional Specifications

**Voltage:** 5 DC

**Current:** < 1.6 Amps

**Max. Consumption:** < 8 Watts

**Ambient Temp.:** 0C to +40C / +32F to +104F

**Operating Re. Humidity:** 90% non-condensing

**Dimensions (HxWxD):**

1.15" x 3.9" x 6.5"

(29.21mm x 99.06mm x 165.10mm)

**Weight:** 0.7lbs (0.317kg)